

DIAL DEPTH GAUGE

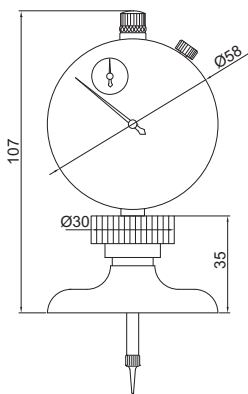

2342-202

Unit: mm



2342-201

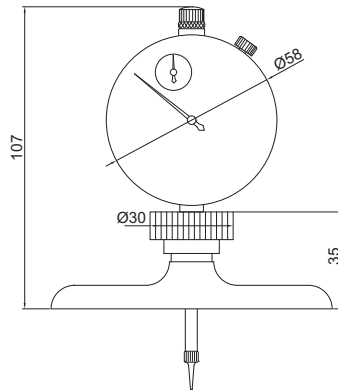

2342-202

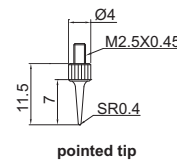
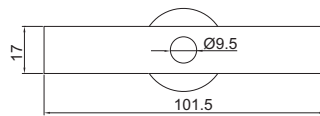
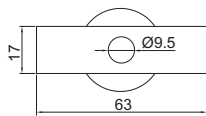

pointed tip

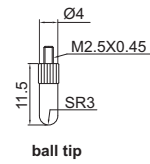

ball tip

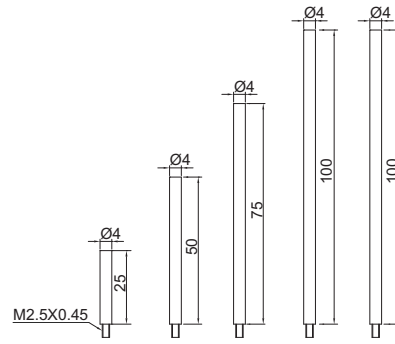

extension rods

- Stainless steel base
- Extension rods: 25mm(1pc), 50mm(1pc), 75mm(1pc), 100mm(2pcs)
- Supplied with pointed tip and ball tip

Code	Range	Dial indicator stroke	Dial indicator graduation	Accuracy	Base
2342-201	0-300mm	30mm	0.01mm	±0.03mm	63x17mm
2342-202	0-300mm	30mm	0.01mm	±0.03mm	101.5x17mm